

SSBL200

规格
Size R0.05 ~ R1



CBN超高速加工用长颈球头铣刀

CBN Super Speed Long Neck Ball End Mill

共有25种规格

Total 25 sizes

L/D最大10倍, 适用于深沟精加工

Capable to machine at deep area finishing by maximum L/D=10

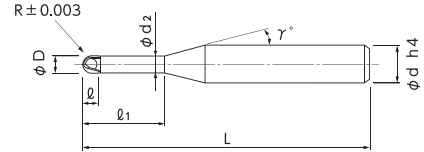

- 可适用于深沟加工。长颈型已经实现系列化!共有25种规格!
- 最大颈长10mm。适用于更深的沟槽加工。
- CBN的延长刀具寿命及长颈设计扩大了加工领域。
- 极小径规格从R0.05起已经实现标准化!
- 采用独创的刀刃形状, R角精度达±0.003, 并提高了耐磨刃性能!
- Lineup of CBN tool with long neck applicable to deep milling, available 25 sizes in total.
- Enables milling more deeply by long under neck length up to 10mm.
- Enables wider application for milling by long neck in addition to long life and accurate finishing.
- Standardized in R0.05 at smallest.
- Unique flute design with R-accuracy ±0.003 prevents chipping!

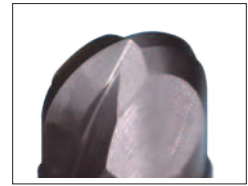

刀刃形状
Cutting edge shape

★返修对应 (柄长须在15mm以上。详情请咨询本公司。)

单位 [规格: mm / 价格: 日元]
Unit [Size: mm / Retail Price: JPY]

| 产品代码 Code No. | (R)球头半径 Radius | (ℓ ₁)颈长 Under Neck Length | (ℓ)刃长 Length of Cut | (D)外径 Dia. | (d ₂)颈径 Neck Dia. | (γ)颈角 Neck Taper Angle | (d)柄径 Shank Dia. | (L)全长 Overall Length | 定价(日元) Retail Price |
|------------------|-------------------|--|------------------------|---------------|----------------------------------|---------------------------|---------------------|-------------------------|------------------------|
| 01-00511-00051 | R0.05 | 0.3 | 0.08 | 0.1 | 0.09 | 15° | 4 | 50 | 38,200 |
| 01-00511-00052 | | 0.5 | 0.08 | 0.1 | 0.09 | 15° | 4 | 50 | 39,800 |
| 01-00511-00075 | R0.075 | 0.45 | 0.12 | 0.15 | 0.14 | 15° | 4 | 50 | 38,200 |
| 01-00511-00076 | | 0.75 | 0.12 | 0.15 | 0.14 | 15° | 4 | 50 | 39,800 |
| 01-00511-00101 | R0.1 | 0.6 | 0.15 | 0.2 | 0.19 | 15° | 4 | 50 | 28,600 |
| 01-00511-00102 | | 1 | 0.15 | 0.2 | 0.19 | 15° | 4 | 50 | 30,000 |
| 01-00511-00151 | R0.15 | 0.9 | 0.23 | 0.3 | 0.28 | 15° | 4 | 50 | 28,600 |
| 01-00511-00152 | | 1.5 | 0.23 | 0.3 | 0.28 | 15° | 4 | 50 | 30,000 |
| ★01-00511-00201 | R0.2 | 1.2 | 0.3 | 0.4 | 0.37 | 15° | 4 | 50 | 26,000 |
| ★01-00511-00202 | | 2 | 0.3 | 0.4 | 0.37 | 15° | 4 | 50 | 27,600 |
| ★01-00511-00251 | R0.25 | 1.5 | 0.38 | 0.5 | 0.46 | 15° | 4 | 50 | 26,000 |
| ★01-00511-00252 | | 2.5 | 0.38 | 0.5 | 0.46 | 15° | 4 | 50 | 27,600 |
| ★01-00511-00301 | R0.3 | 3 | 0.5 | 0.6 | 0.56 | 15° | 4 | 50 | 25,600 |
| ★01-00511-00302 | | 4 | 0.5 | 0.6 | 0.56 | 15° | 4 | 52 | 25,600 |
| ★01-00511-00303 | | 5 | 0.5 | 0.6 | 0.56 | 15° | 4 | 52 | 26,000 |
| ★01-00511-00401 | R0.4 | 4 | 0.6 | 0.8 | 0.76 | 12° | 4 | 53 | 25,600 |
| ★01-00511-00501 | R0.5 | 4 | 0.7 | 1 | 0.95 | 12° | 4 | 53 | 25,600 |
| ★01-00511-00502 | | 5 | 0.7 | 1 | 0.95 | 12° | 4 | 53 | 25,600 |
| ★01-00511-00504 | | 6 | 0.7 | 1 | 0.95 | 15° | 4 | 53 | 25,600 |
| ★01-00511-00506 | | 8 | 0.7 | 1 | 0.95 | 15° | 4 | 53 | 26,000 |
| ★01-00511-00508 | | 10 | 0.7 | 1 | 0.95 | 15° | 4 | 53 | 26,600 |
| ★01-00511-00751 | R0.75 | 7.5 | 1 | 1.5 | 1.45 | 15° | 4 | 52 | 27,600 |
| ★01-00511-01001 | R1 | 6 | 1.2 | 2 | 1.94 | 15° | 4 | 52 | 25,000 |
| ★01-00511-01003 | | 8 | 1.2 | 2 | 1.94 | 15° | 4 | 52 | 27,600 |
| ★01-00511-01005 | | 10 | 1.2 | 2 | 1.94 | 15° | 4 | 52 | 27,600 |

订购方法
How to Order

请指定SSBL200 球头半径(R)×颈长(ℓ₁)。
When you order, indicate SSBL200 (R)×(ℓ₁).

※(γ)为参考值。
※(γ) is reference value.

球头
Long Neck
Ball
无涂层
Non-Coating

高硬度钢~52 HRC
高硬度钢~60 HRC
高硬度钢~65 HRC
高硬度钢~70 HRC

CBN
核心系列
CBN
Core Line