

MHDH645

规格
Size $\phi 5 \sim \phi 12$

Premium ≤ 65 HRC

无限白金涂层 高硬度钢材用6刃平底铣刀

MUGEN COATING PREMIUM 6-Flute Square End Mill For Hardened Steel

共有10种规格
Total 10 sizes

6刃强螺旋角，可对应高硬度钢（~65HRC）的精加工

6-flute with high helix angle. For finishing of hardened steels (~65HRC)

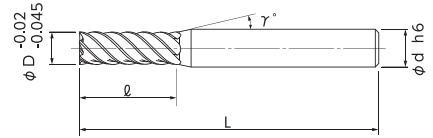
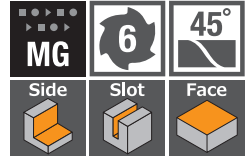

- 刃长有2D和3D类型。
- 在高硬度领域（48~65HRC）的长时间加工中也可实现稳定的延长刀具寿命。
- 改进了刀刃形状，改善了倾斜量和加工精度。
- L/D=2 and L/D=3 length of cut selection.
- Realized stably long tool life against high hardened steels (48~65HRC).
- Improved milling deflection and accuracy by advanced flute design.

★返修对应（柄长须在15mm以上。详情请咨询本公司。）

单位 [规格: mm / 价格: 日元]
Unit [Size: mm / Retail Price: JPY]

产品代码 Code No.	(D)外径 Dia.	(ℓ)刃长 Length of Cut	(γ)颈角 Neck Taper Angle	(d)柄径 Shank Dia.	(L)全长 Overall Length	定价(日元) Retail Price
★ 08-00428-00500	5	10	12°	6	60	9,200
★ 08-00428-00501		15	12°	6	65	10,200
★ 08-00428-00600	6	12	—	6	60	10,000
★ 08-00428-00601		18	—	6	65	11,100
★ 08-00428-00800	8	16	—	8	65	13,600
★ 08-00428-00801		24	—	8	70	15,200
★ 08-00428-01000	10	20	—	10	75	18,200
★ 08-00428-01001		30	—	10	80	20,200
★ 08-00428-01200	12	24	—	12	80	23,200
★ 08-00428-01201		36	—	12	90	25,700

订购方法
How to Order

请指定MHDH645 外径(D)×刃长(ℓ)。
When you order, indicate MHDH645 (D)×(ℓ).

※(γ)为参考值。
※(γ) is reference value.

- 调质钢 P
Prehardened Steel
- 高硬度钢~52 HRC H
Hardened Steel HRC
- 高硬度钢~60 HRC H
Hardened Steel HRC
- 高硬度钢~65 HRC H
Hardened Steel HRC

常规系列
无限白金涂层
全刃长造型
Regular Line
MUGEN PREMIUM
Full Cutting Length Type